

Detailblatt 12-920
 Dämmung Dach 12-200: 240mm
 Dämmung Wand 24-110: 16 + 120 + 60mm
 Kriterium Schimmel

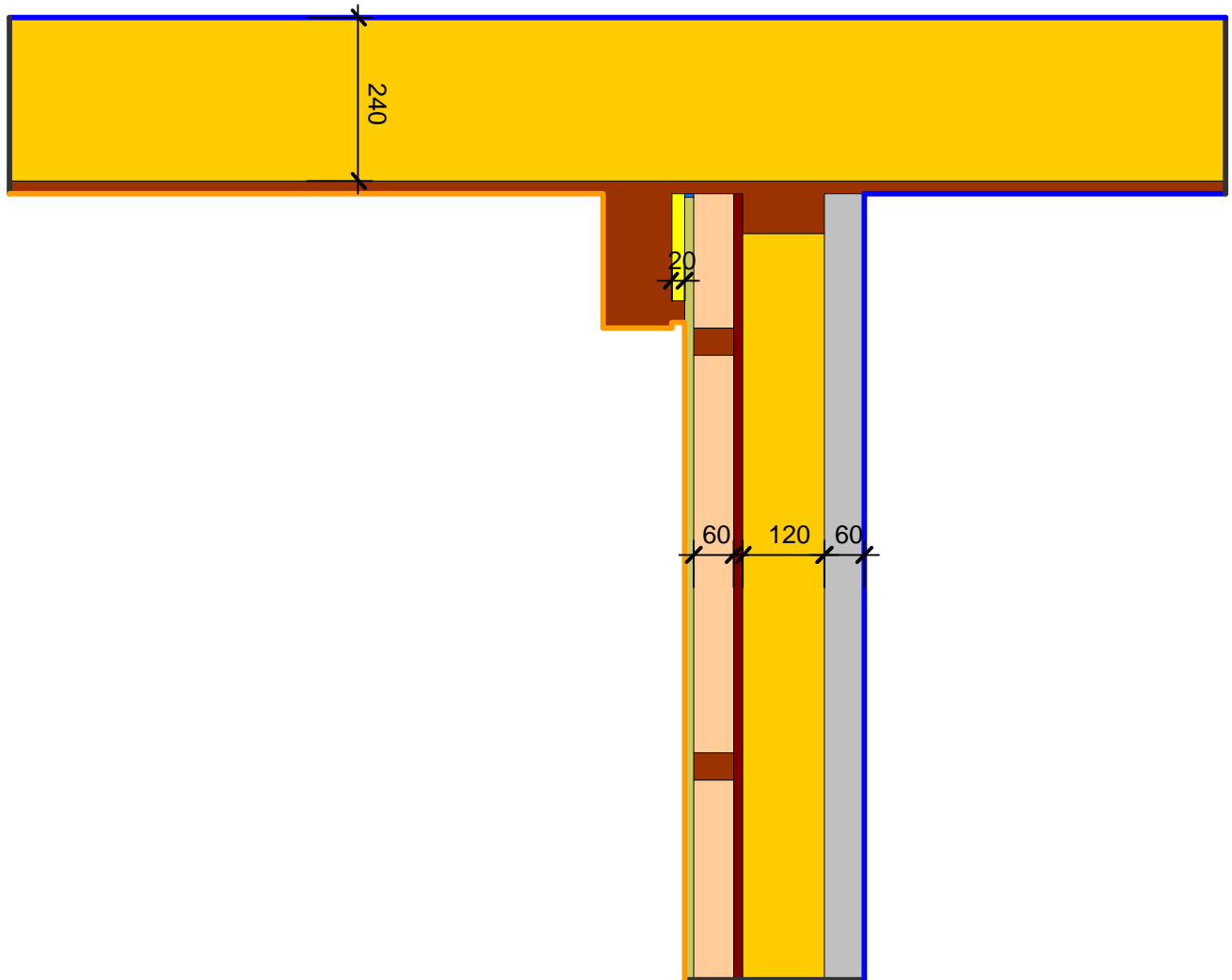

Material	λ [W/(m·K)]	Randbedingung	q [W/m ²]	θ [°C]	R [(m ² ·K)/W]	ϵ
Fichte, Tanne	0.140	Aussenklima		8.400	0.040	
Gips	0.400	Innen Obere Raumbälfte		20.000	0.250	
Holzspanplatte 600	0.110	Symmetrie/Bauteilschnitt	0.000			
ISOVER ISOLENE P	0.032					
ISOVER ISOPONTE	0.032					
ISOVER PB M 032	0.032					
ISOVER SPARRENPLATTE 032 PR	0.032					
Unbelüftete Hohlräume	Eps=0.9/0.9					

ISOVER Bautechnik, November 2013

Detailblatt 12-920
Dämmung Dach 12-200: 240mm
Dämmung Wand 24-110: 16 + 120 + 60mm
Kriterium Schimmel

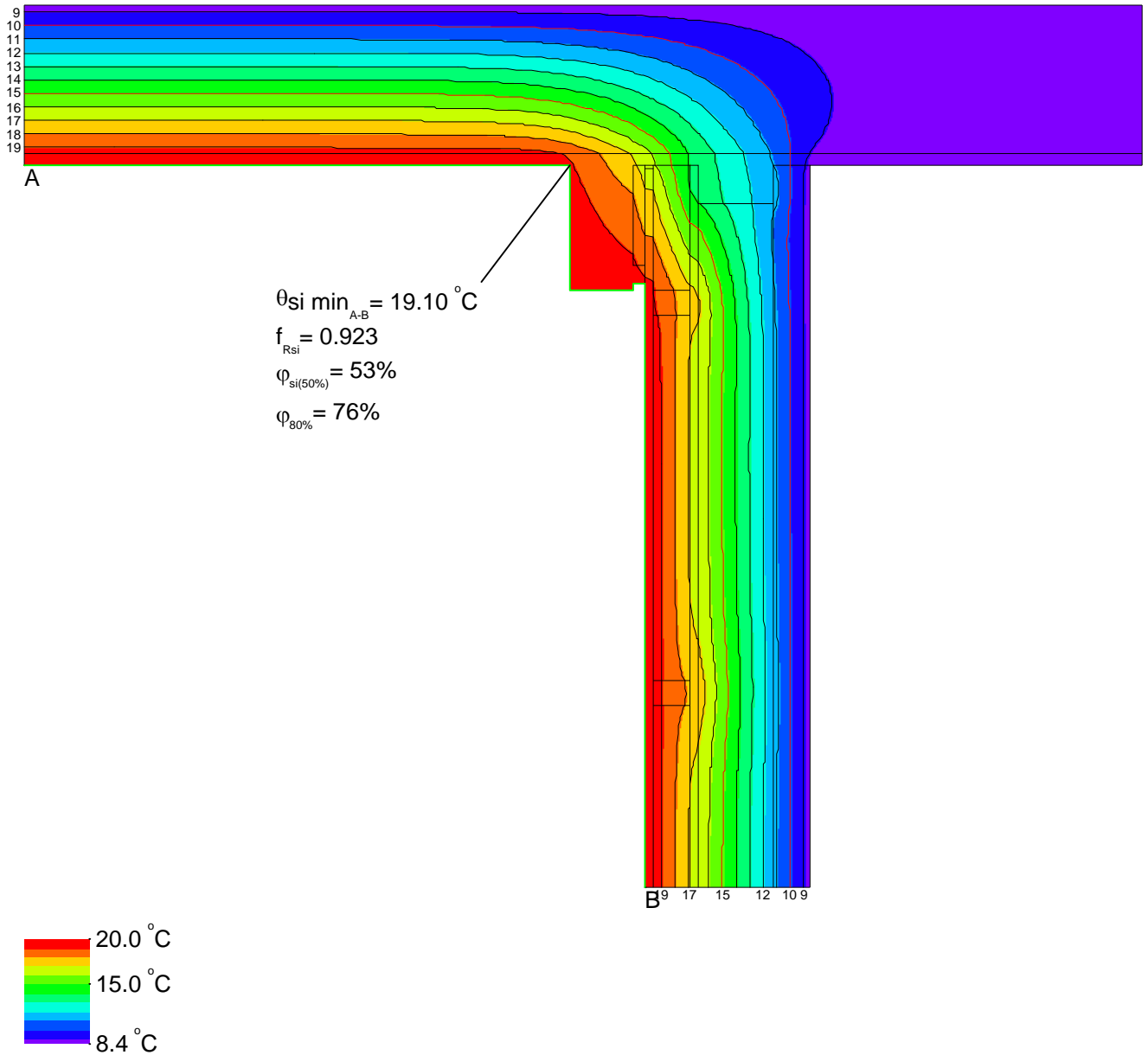

ISOVER Bautechnik, November 2013