

Detailblatt 24-900  
 Dämmung Dach 11-220: 180 + 80mm  
 Dämmung Wand 24-110: 60 + 120 + 60mm  
 Psi-Wert

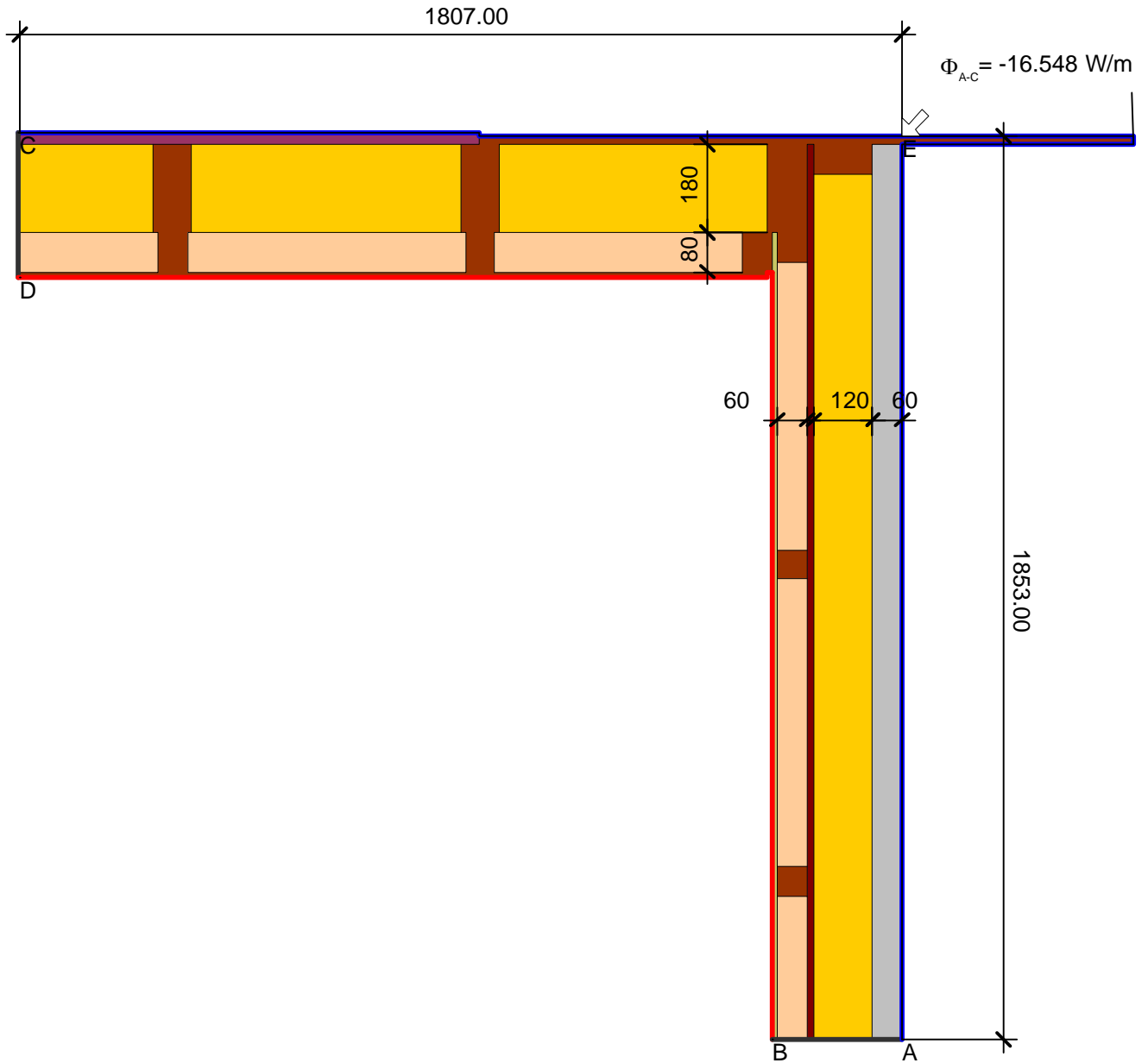

$$\Psi_{A-E-C,*} = \frac{\Phi}{\Delta T} - U_1 \cdot b_1 - U_2 \cdot b_2 = \frac{16.548}{34.600} - 0.150 \cdot 1.853 - 0.150 \cdot 1.807 = -0.07 \text{ W/(m}\cdot\text{K)}$$

Material	$\lambda$ [W/(m·K)]	Randbedingung	$q$ [W/m <sup>2</sup> ]	$\theta$ [°C]	$R$ [(m <sup>2</sup> ·K)/W]	$\varepsilon$
Fichte, Tanne	0.140	Aussen stark belüftet	-14.600	20.000	0.130	
Gips	0.400	Innen Standard		20.000	0.130	
Holzspanplatte 600	0.110	Innen Wärmestrom aufwärts		20.000	0.100	
ISOVER ISOCONFORT 032	0.032	Symmetrie/Bauteilschnitt	0.000			
ISOVER ISOPONTE	0.032					
ISOVER SPARENPLATTE 032 PR	0.032					
Isorooft Natur	0.047					

ISOVER Bautechnik, August 2013

Detailblatt 24-900  
Dämmung Dach 11-220: 180 + 80mm  
Dämmung Wand 24-110: 60 + 120 + 60mm  
Psi-Wert

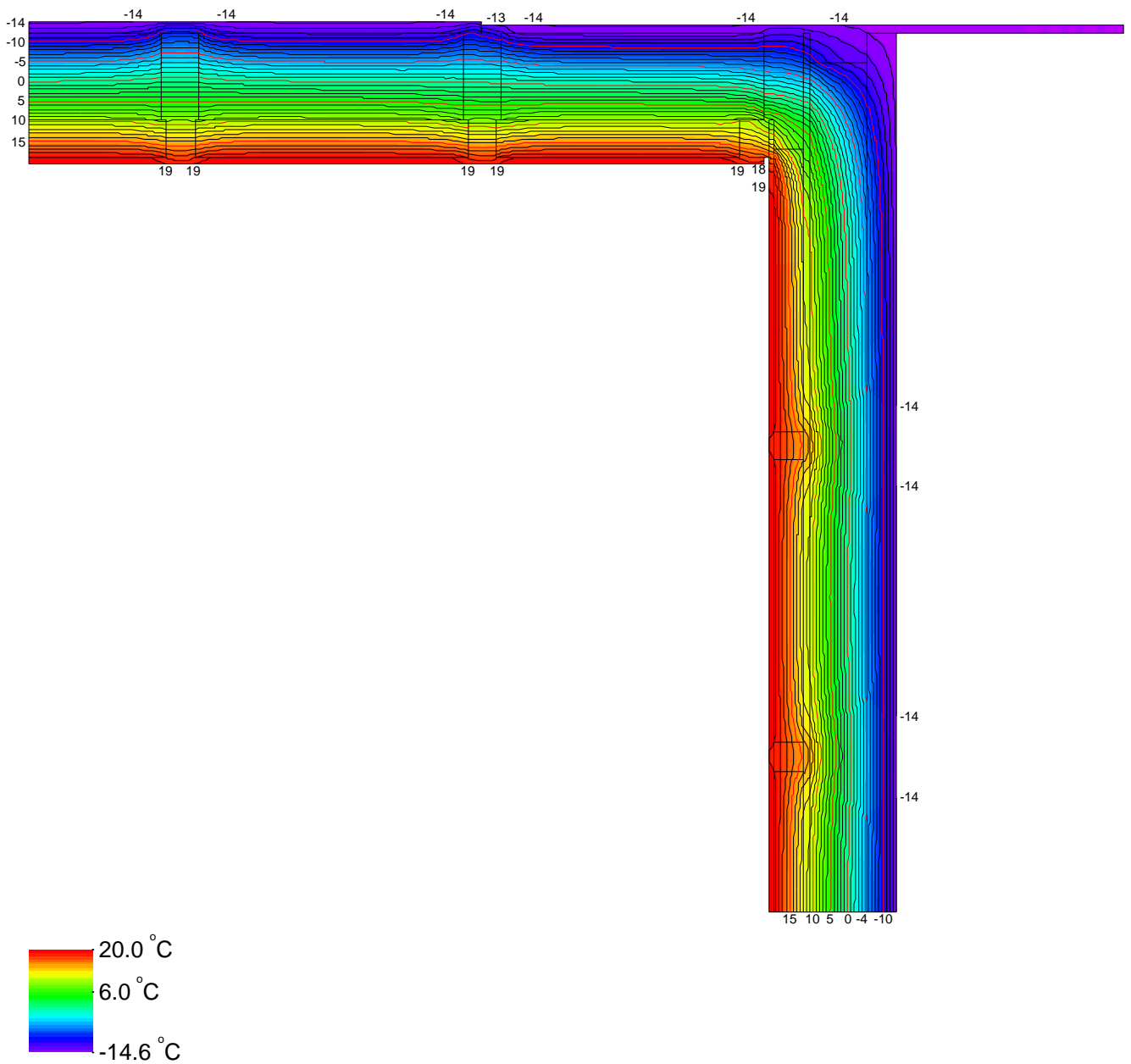

ISOVER Bautechnik, August 2013