

Detailblatt 12-965
 Dämmung Dach 12-300: 100 + 100mm
 Kriterium Schimmel

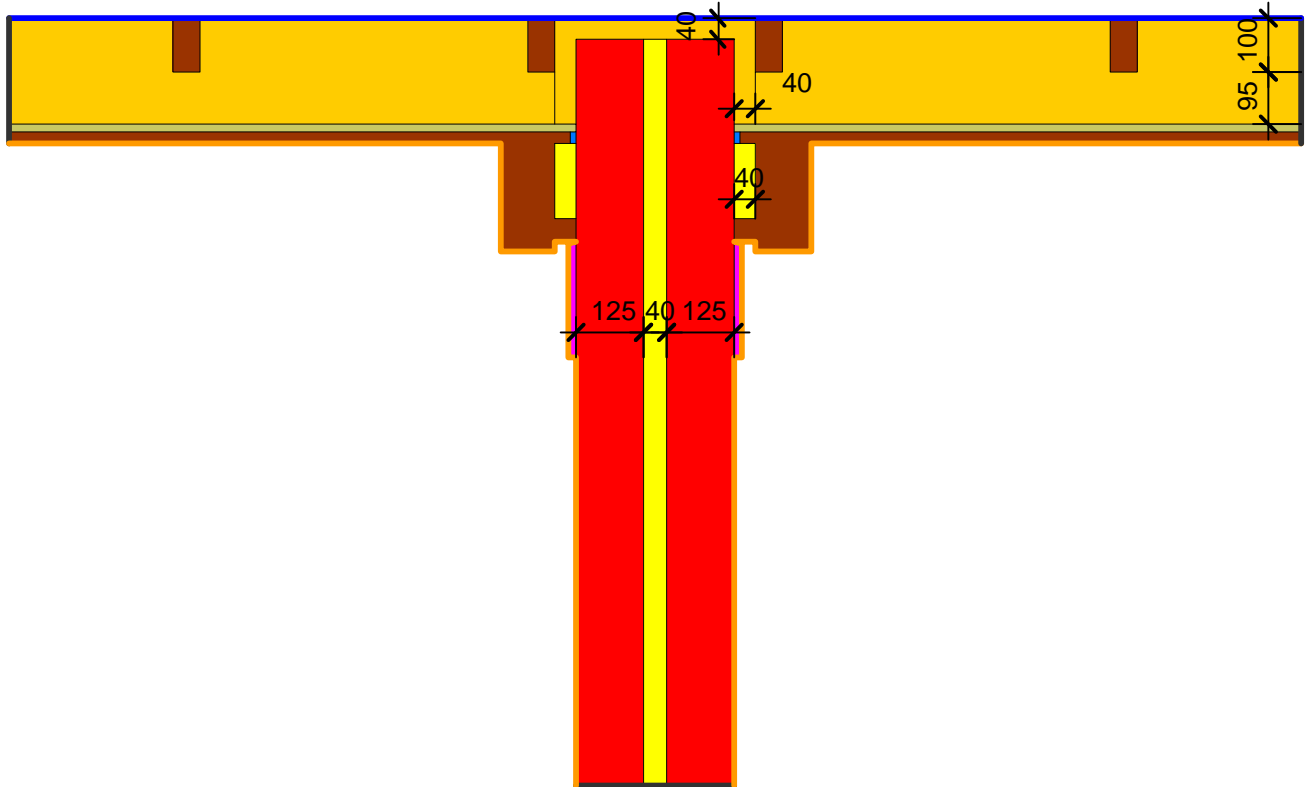

Material	λ [W/(m·K)]	Randbedingung	q [W/m ²]	θ [°C]	R [(m ² ·K)/W]	ε
Fichte, Tanne	0.140	Aussenklima		8.400	0.040	
Gips	0.400	Innen Obere Raumhälfte		20.000	0.250	
ISOVER ISOTHERM 035	0.035	Symmetrie/Bauteilschnitt	0.000			
ISOVER PB M 035	0.035					
ISOVER SPARRENPLATTE 032 PR	0.032					
Innenputz	0.700					
Modulbackstein Einstein	0.440					
Unbelüftete Hohlräume	Eps=0.9/0.9					

Detailblatt 12-965
Dämmung Dach 12-300: 100 + 100mm
Kriterium Schimmel

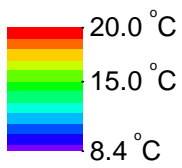
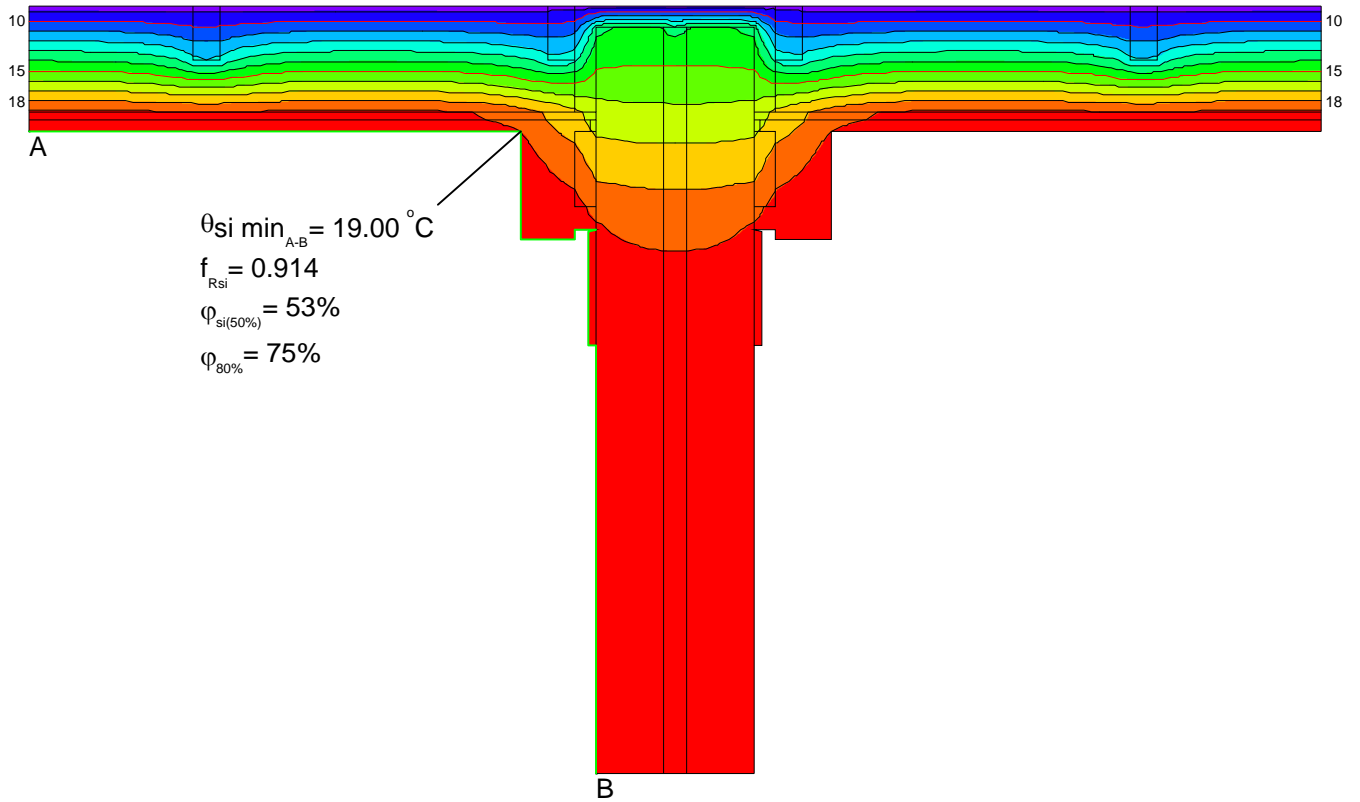

ISOVER Bautechnik, November 2013