

Detailblatt 12-955-v1
 Dämmung Dach 12-300: 120 + 140mm
 Dämmung Wand 24-110: 60 + 120 + 60mm
 Kriterium Schimmel

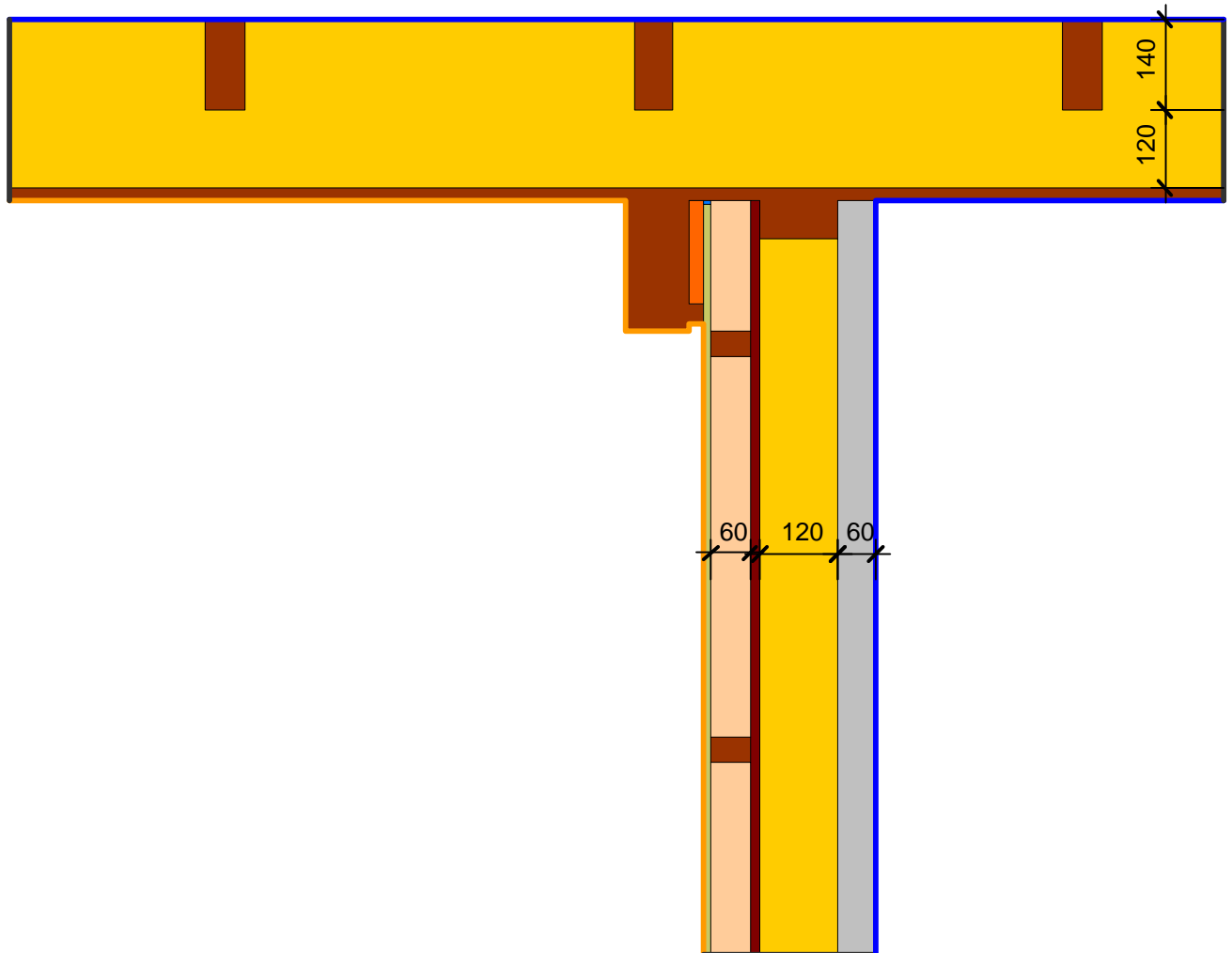

Material	λ [W/(m·K)]	Randbedingung	q [W/m ²]	θ [°C]	R [(m ² ·K)/W]	ε
Fichte, Tanne	0.140	Aussenklima		8.400		0.040
Gips	0.400	Innen Obere Raumhälfte		20.000		0.250
Holzspanplatte 600	0.110	Symmetrie/Bauteilschnitt	0.000			
ISOVER ISOLENE P	0.032					
ISOVER ISOPONTE	0.032					
ISOVER ISOTHERM 035	0.035					
ISOVER PB M 032	0.032					
ISOVER SPARENPLATTE 032 PR	0.032					
Unbelüftete Hohlräume	Eps=0.9/0.9					

ISOVER Bautechnik, November 2013

Detailblatt 12-955-v1
 Dämmung Dach 12-300: 120 + 140mm
 Dämmung Wand 24-110: 60 + 120 + 60mm
 Kriterium Schimmel

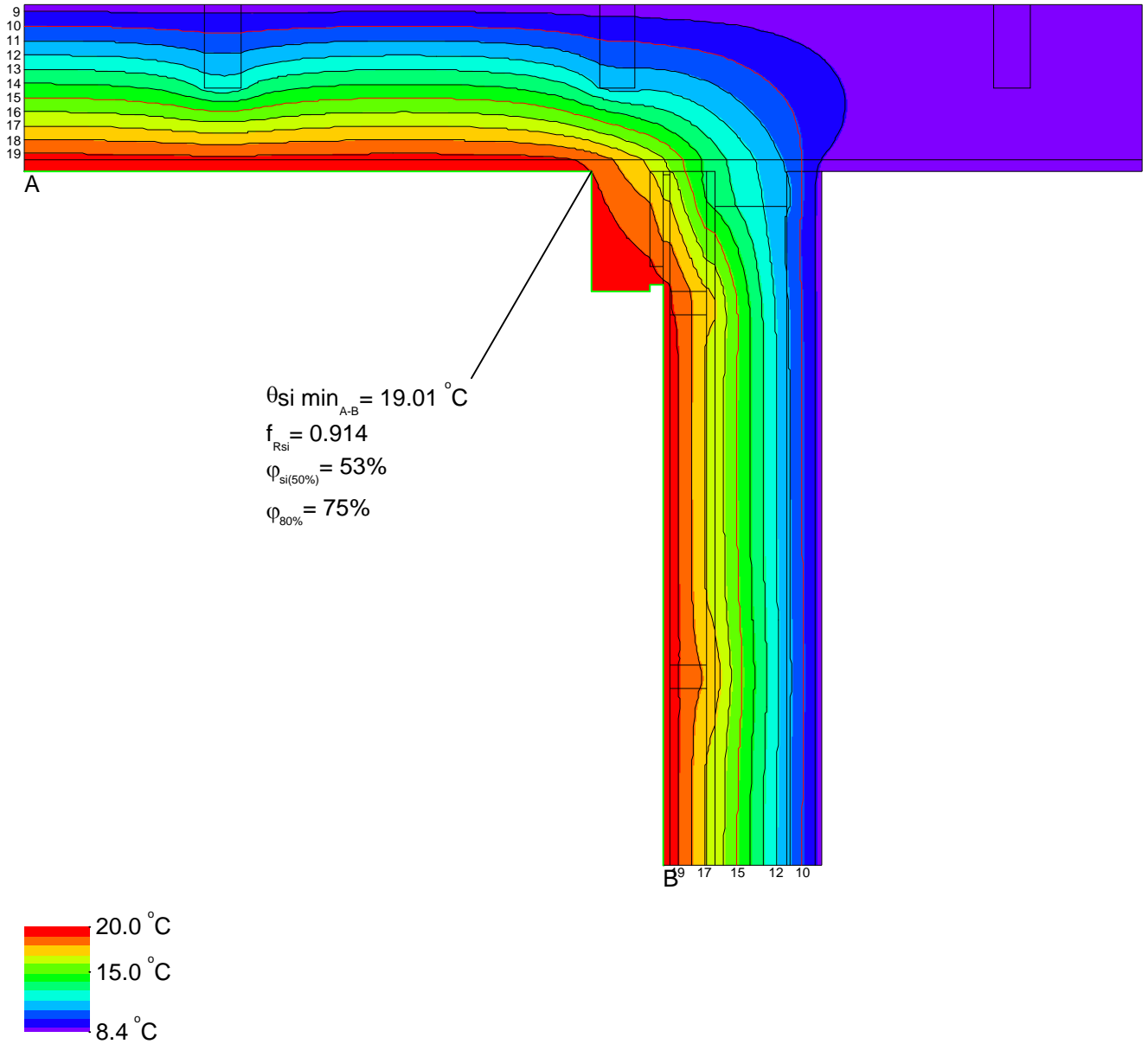

ISOVER Bautechnik, November 2013